

型式	容量 cm <sup>3</sup> /rev	無負荷時吐出量 ℓ/min				最高容許壓力 bar	迴轉速度 min <sup>-1</sup>		質量 kg
		1000min <sup>-1</sup>	1200min <sup>-1</sup>	1500min <sup>-1</sup>	1800min <sup>-1</sup>		Min	Max	
P08-A*-F-R-01	8.0	8.0	9.6	12.0	14.4	255	300	2000	9
P16-A*-F-R-01	16.5	16.5	19.8	24.7	29.7		300	2000	13
P22-A*-F-R-01	22.0	22.0	26.4	33.0	39.6		300	2000	13
P36-A*-F-R-01	36.0	36.0	43.2	54.0	64.8		300	2000	24
P46-A*-F-R-01	46.0	46.0	55.2	69.0	82.8		300	2000	24
P70-A*-F-R-01	70.0	70.0	84.0	105.0	126.0	286	300	1800	43
P100-A*-F-R-01	100.0	100.0	120.0	150.0	180.0		300	1800	62

## 壓力補償控制型

### 型式規格說明

P16	-A3	-F	-R	(-S)	-01
可變容量柱塞泵浦 理論吐出容量(cm <sup>3</sup> /rev)	A * : 壓力補償控制型 壓力調整範圍	安裝型式	迴轉方向 (從軸心端看)	軸心型式	設計番號
P08 (8.0)	A0 : 15~45 bar A1 : 20~75 bar A2 : 25~145 bar A3 : 30~215 bar	F : 法蘭安裝型 L : 腳座安裝型	R : 右向 (標準) L : 左向 (特殊)	K : 平鍵軸式-標準型式 (代號省略) S : 花鍵軸心-特殊型式 P08 - SAE-9T P16 P22 P36 - SAE-13T P46 P70 - SAE-14T P100 - SAE-17T	
P16 (16.5)					
P22 (22.0)					
P36 (36.0)					
P46 (46.0)					
P70 (70.0)	A2 : 25~145 bar A3 : 30~215 bar	F : 法蘭安裝型 L : 無製造	R : 右向 (標準) L : 無製造		
P100 (100.0)	A4 : 30~286 bar				

### P08-A\*-F-R-TYPE

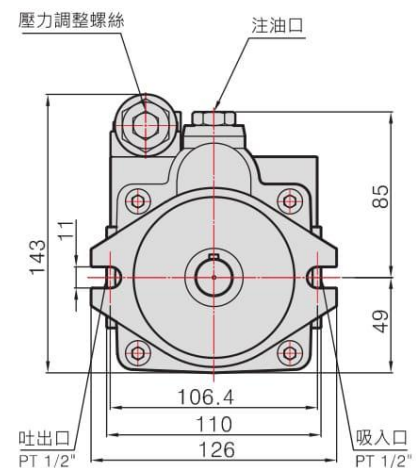
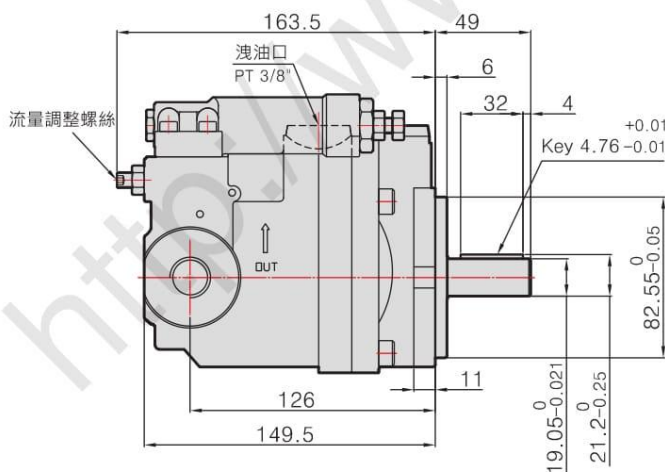

#### 花鍵軸心

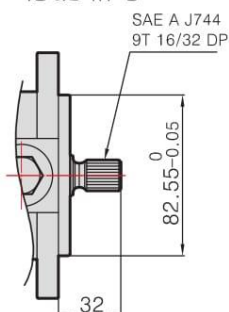

#### 吸入口側

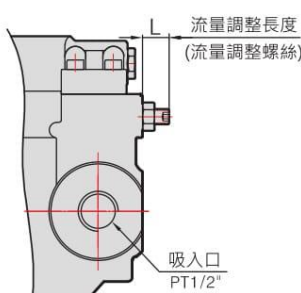

流量調整螺絲長度(L)與容量(q)的變化關係

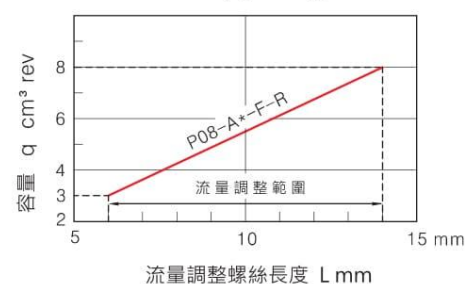

## P16/P22-A\*-F-R-TYPE

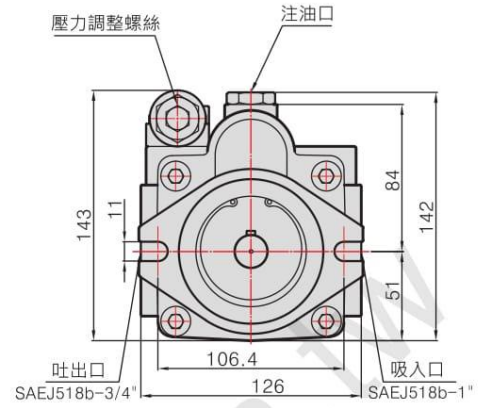
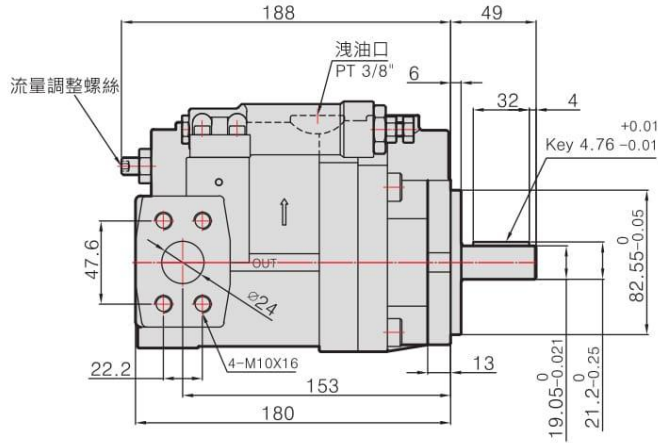

### 花鍵軸心

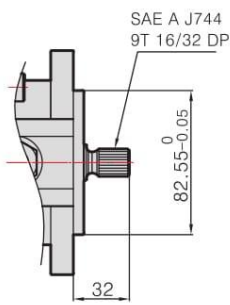

### 吸入口側

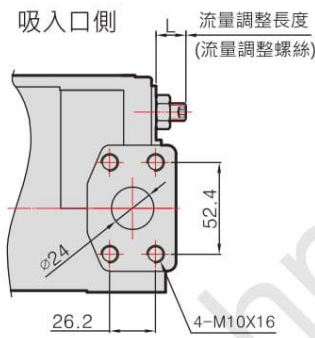

流量調整螺絲長度(L)與容量(q)的變化關係

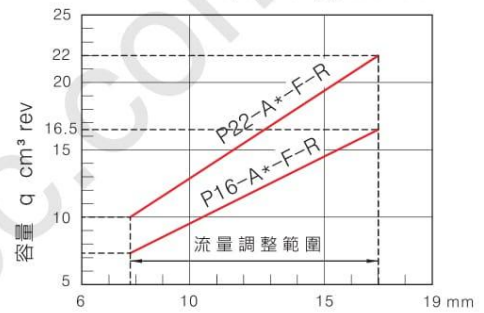

流量調整螺絲長度 L mm

## P36/P46-A\*-F-R-TYPE

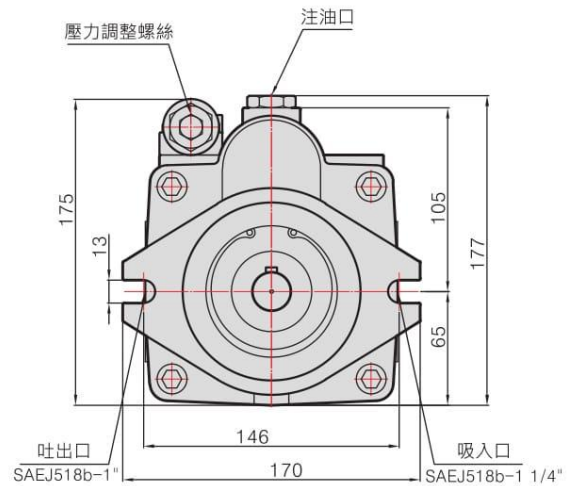
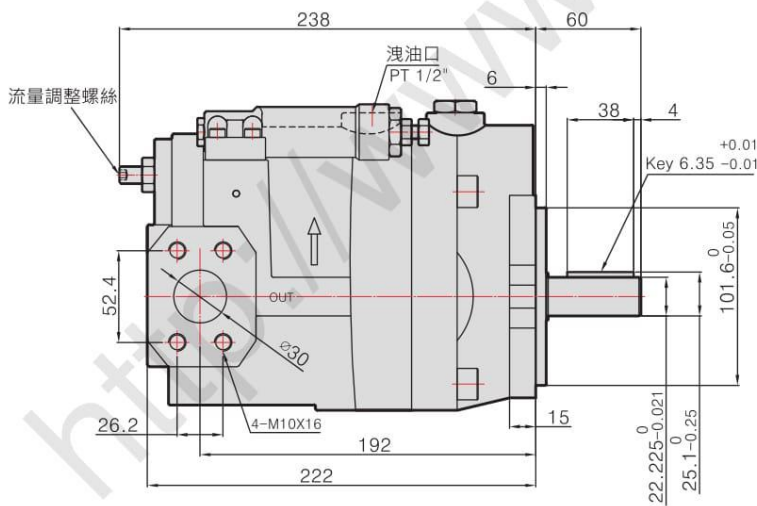

### 花鍵軸心

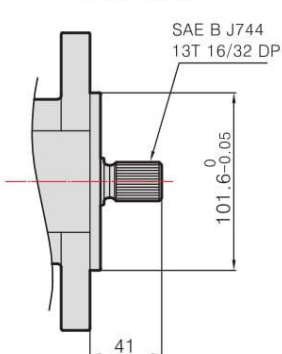

### 吸入口側

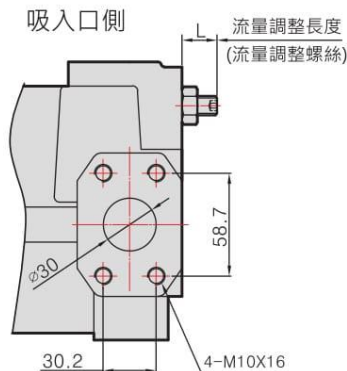

流量調整螺絲長度(L)與容量(q)的變化關係

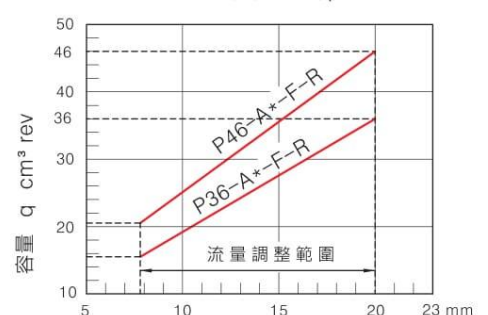

流量調整螺絲長度 L mm

## P70-A\*-F-R-TYPE

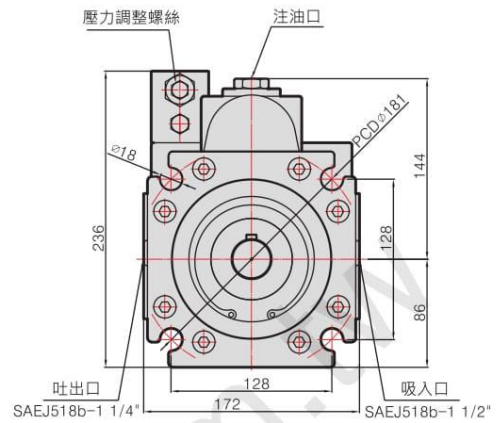
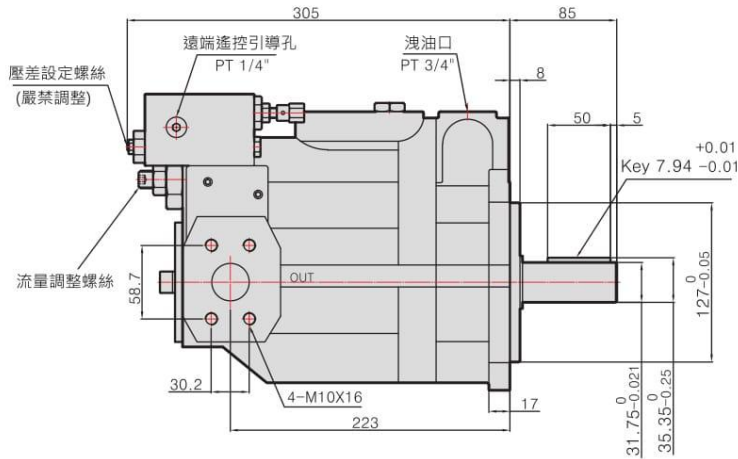

花鍵軸心

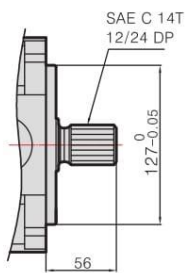

吸入口側

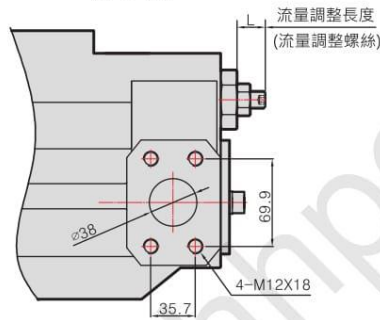

流量調整螺絲長度(L)與容量(q)的變化關係

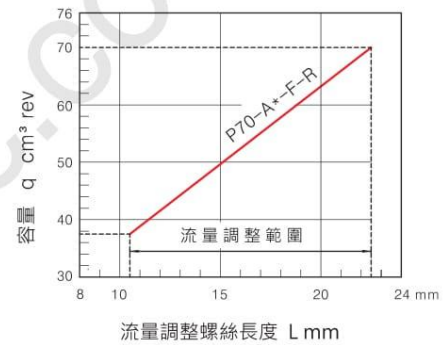

## P100-A\*-F-R-TYPE

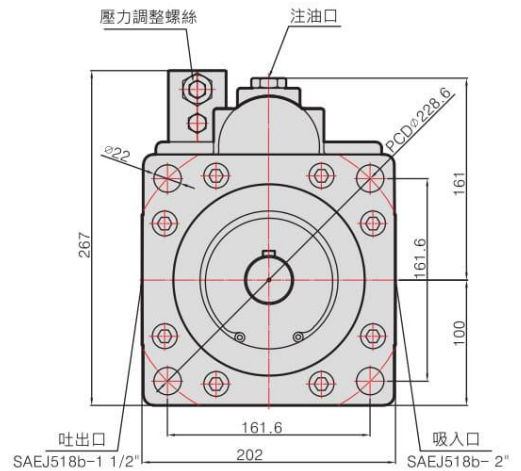
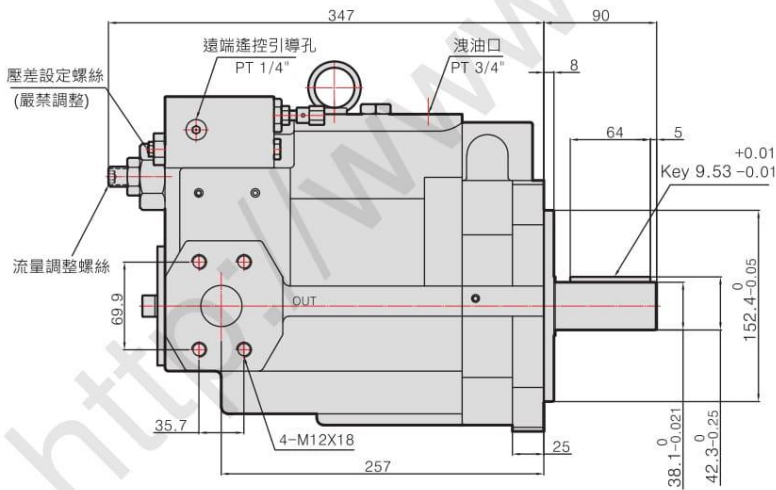

花鍵軸心

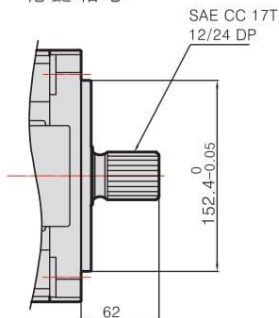

吸入口側

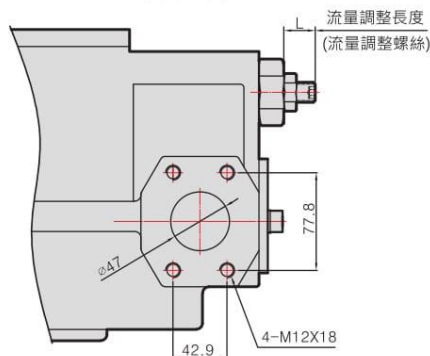

流量調整螺絲長度(L)與容量(q)的變化關係

