

Brackets and Levers

YT-1000R Bracket Series

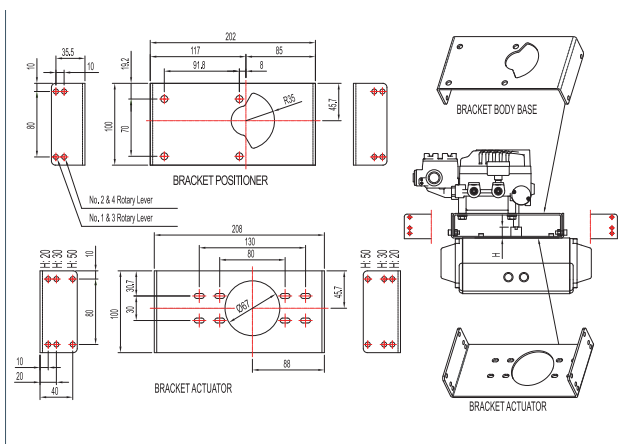

YT-1200R Bracket Series

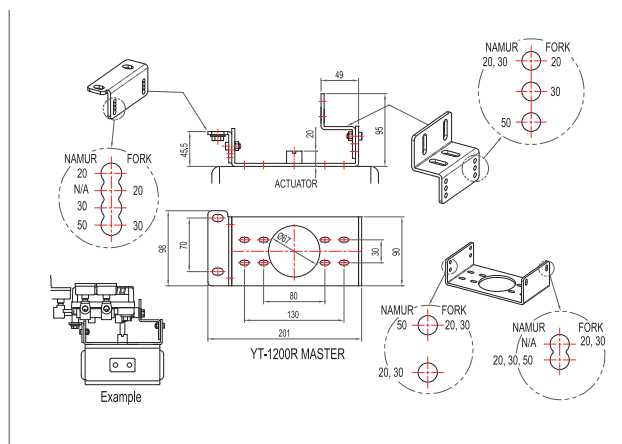

YT-2500R & 2550R & 2600R & 3303R & 3400R & 3450R Bracket Series

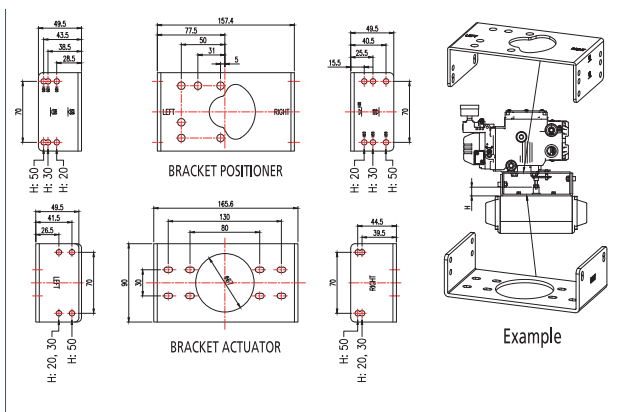

YT-3300R & 3350R & 3700R & 3750R Bracket Series

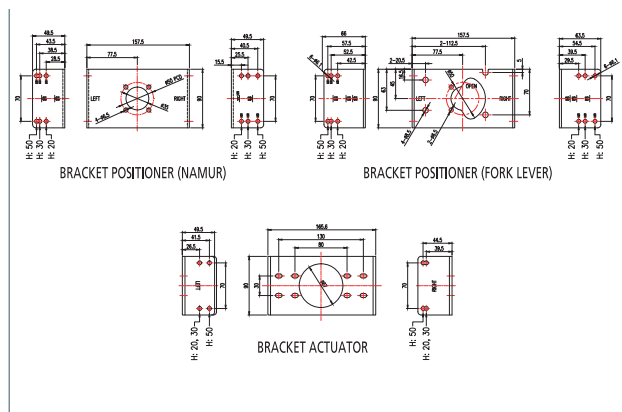

Linear Type Namur Bracket Series

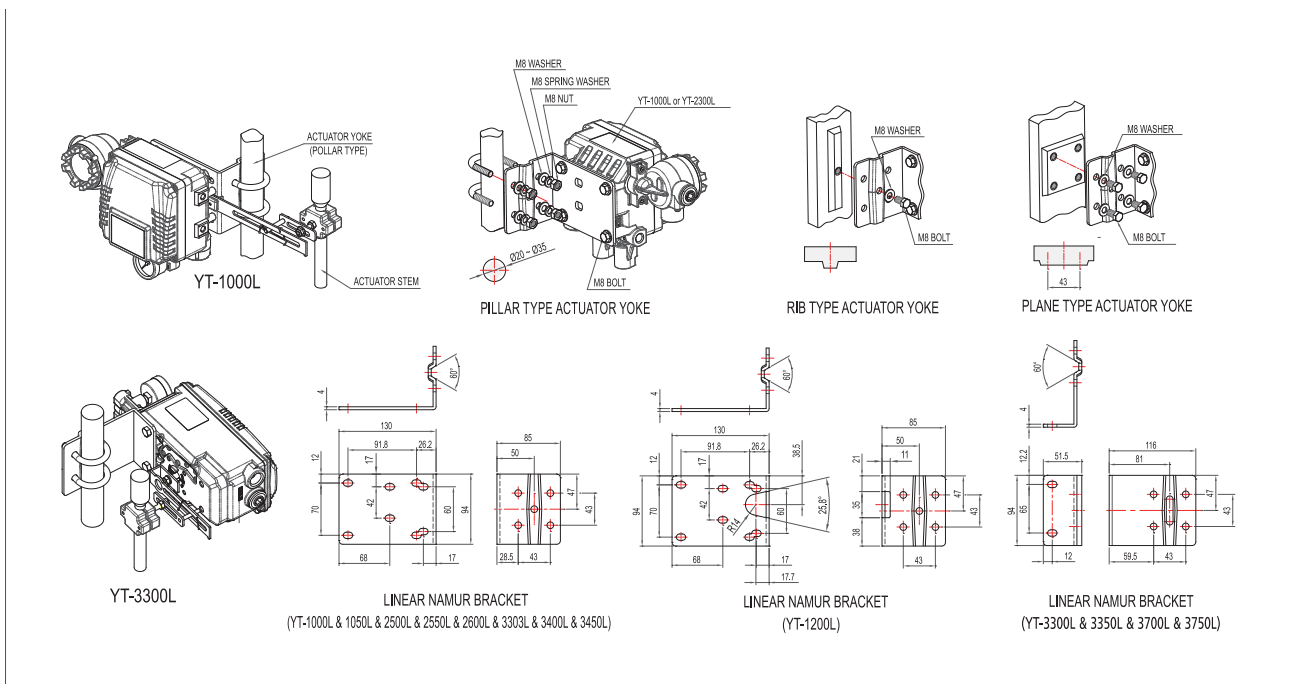

Brackets and Levers

YT-850 & 870 & 875 Bracket Series

Technical drawings of the YT-850 & 870 & 875 Bracket Series. The drawings include a perspective view of the bracket assembly, a top view showing dimensions L1 and L2, and a side view showing dimensions H1 and H2. A table provides the dimensions for different bracket types.

Bracket Type	H1	H2	L1	L2
ST-1	20	30.5	80	100
ST-2	30	40.5		
ST-3	30	40.5		
ST-4	50	60.5	130	150

UNIT: mm

Lever Series

Technical drawings and tables for various lever series. The drawings include dimensions for L1, L2, and Stroke, and tables providing specific data for each type.

YT-1000 & 1200 Linear Type

Lever Type	Stroke	L1	L2
1	10 - 40	121.2	68.2
2	30 - 70	195	120
3	60 - 100	277	122
4	100 - 150	400	

UNIT: mm

SPTM-5V Rotary Standard Lever Type

Technical drawing showing dimensions: 6, 20, 67, 93.

SPTM-6V & SPTM-65V Rotary Standard Lever Type

Technical drawing showing dimensions: 6, 20, 153.5, 163.5.

YT-2500 & 2550 & 2600 & 3303 & 3400 & 3450 SPTM-5V & SPTM-6V & SPTM-65V Linear Type

Lever Type	Stroke	L1	L2
1	10 - 40	93	67
2	20 - 70	153.5	106.5
3	50 - 100	214	117
4	100 - 150	307.3	

UNIT: mm

Rotary Fork Lever Type

Lever Type	L1	L2	M
1	34	9	M
2	63	37	M6
3	34	9	M8
4	63	37	

UNIT: mm

Rotary Namur Lever Type

Model	L1	L2
E/P & P/P Positioner	7	11
Smart Positioner & SPTM-6V & SPTM-65V	4	8
SPTM-5V	4	9
YT-850 & 870 & 875	3	7

UNIT: mm

YT-3300 & 3350 & 3700 & 3750 Linear Type

Lever Type	Stroke	L1	L2	L3
0 (Standard)	10 - 40	45	55	40.9
1 (Standard)	20 - 100	91	115	
2 (Standard)	90 - 50	85	165	
3 (Adapter)	16 - 30	27	43	
4 (Adapter)	16 - 60	64	80	
5 (Adapter)	16 - 100	96	113	
6 (Adapter)	90 - 150	80	167	YT-3300 YT-3350 Only

UNIT: mm