

滿載電流表 Full Load Current Chart

unit:Amp

3 PHASE - 50Hz

HP	Pole	Kw	RPM	kg	200V	208V	220V	230V	240V	346V	380V	400V	415V	440V	460V	480V	575V	660V
1/4	4P	0.18	1420		1.87	1.80	1.7	1.63	1.56	1.08	0.98	0.94	0.9	0.85	0.81	0.78	0.65	0.57
1/2		0.37	1420	13	2.20	2.12	2.0	1.91	1.83	1.27	1.16	1.1	1.06	1.00	0.96	0.92	0.77	0.67
1		0.75	1420	16	4.0	3.8	3.6	3.4	3.3	2.3	2.1	2.0	1.9	1.8	1.7	1.65	1.4	1.2
2		1.5	1420	22	6.9	6.7	6.3	6.0	5.8	4.0	3.6	3.5	3.3	3.2	3.0	2.9	2.4	2.1
3		2.2	1430	30	10.2	9.8	9.3	8.9	8.5	5.9	5.4	5.1	4.9	4.7	4.4	4.3	3.6	3.1
5		3.7	1430	38	15.8	15.2	14.4	13.8	13.2	9.2	8.3	7.9	7.6	7.2	6.9	6.6	5.5	4.8
7.5		5.5	1440	65	24.0	23.1	21.8	20.9	20.0	13.9	12.6	12.0	11.6	10.9	10.4	10.0	8.3	7.3
10		7.5	1440	73	32.8	31.5	29.8	28.5	27.3	18.9	17.3	16.4	15.8	14.9	14.3	13.7	11.4	9.9
15		11	1440	120	46.6	44.8	42.4	40.6	38.9	27.0	24.5	23.3	22.5	21.2	20.3	19.4	16.2	14.1
20		15	1440	150	63.8	61.3	58.0	55.5	53.2	36.9	33.6	31.9	30.7	29.0	27.7	26.6	22.2	19.3
25		18.5	1440	180	78.1	75.1	71.0	67.9	65.1	45.1	41.1	39.1	37.6	35.5	34.0	32.5	27.2	23.7
30		22	1440	220	91.3	87.8	83.0	79.4	76.1	52.8	48.1	45.7	44.0	41.5	39.7	38.0	31.8	27.7
40		30	1440	240	123.2	118.5	112.0	107.1	102.7	71.2	64.8	61.6	59.4	56.0	53.6	51.3	42.9	37.3
1/4		6P	0.18	940	13	1.98	1.90	1.80	1.72	1.65	1.14	1.04	0.99	0.95	0.90	0.86	0.83	0.69
1/2	0.37		940	16	3.19	3.07	2.90	2.77	2.66	1.84	1.68	1.60	1.54	1.45	1.39	1.33	1.11	0.97
1	0.75		940	22	5.1	4.9	4.6	4.4	4.2	2.9	2.7	2.5	2.4	2.3	2.2	2.1	1.8	1.5
2	1.5		940	30	8.5	8.1	7.7	7.4	7.1	4.9	4.5	4.2	4.1	3.9	3.7	3.5	2.9	2.6
3	2.2		940	38	11.6	11.1	10.5	10.0	9.6	6.7	6.1	5.8	5.6	5.3	5.0	4.8	4.0	3.5
5	3.7		940	65	18.7	18.0	17.0	16.3	15.6	10.8	9.8	9.4	9.0	8.5	8.1	7.8	6.5	5.7
7.5	5.5		940	73	27.5	26.4	25.0	23.9	22.9	15.9	14.5	13.8	13.3	12.5	12.0	11.5	9.6	8.3
10	7.5		940	120	36.3	34.9	33.0	31.6	30.3	21.0	19.1	18.2	17.5	16.5	15.8	15.1	12.6	11.0
15	11		940	150	51.7	49.7	47.0	45.0	43.1	29.9	27.2	25.9	24.9	23.5	22.5	21.5	18.0	15.7
20	15		940	180	73.7	70.9	67.0	64.1	61.4	42.6	38.8	36.9	35.5	33.5	32.0	30.7	25.6	22.3
25	18.5		950	220	82.5	79.3	75.0	71.7	68.8	47.7	43.4	41.3	39.8	37.5	35.9	34.4	28.7	25.0
30	22		950	240	104.5	100.5	95.0	90.9	87.1	60.4	55.0	52.3	50.4	47.5	45.4	43.5	36.3	31.7

3 PHASE - 60Hz

HP	Pole	kW	RPM	kg	200V	208V	220V	230V	240V	346V	380V	400V	415V	440V	460V	480V	575V	660V
1/4	4P	0.18	1720		1.54	1.48	1.40	1.34	1.28	0.89	0.81	0.77	0.74	0.70	0.67	0.64	0.54	0.47
1/2		0.37	1720	13	1.87	1.80	1.70	1.63	1.56	1.08	0.98	0.94	0.90	0.85	0.81	0.78	0.65	0.57
1		0.75	1720	16	3.9	3.7	3.5	3.3	3.2	2.2	2.0	1.93	1.86	1.8	1.7	1.6	1.3	1.2
2		1.5	1720	22	6.3	6.0	5.7	5.5	5.2	3.6	3.3	3.1	3.0	2.9	2.7	2.6	2.2	1.9
3		2.2	1720	30	9.6	9.2	8.7	8.3	8.0	5.5	5.0	4.8	4.6	4.4	4.2	4.0	3.3	2.9
5		3.7	1740	38	15.3	14.7	13.9	13.3	12.7	8.8	8.0	7.6	7.4	7.0	6.6	6.4	5.3	4.6
7.5		5.5	1740	65	22.2	21.4	20.2	19.3	18.5	12.8	11.7	11.1	10.7	10.1	9.7	9.3	7.7	6.7
10		7.5	1740	73	30.1	29.0	27.4	26.2	25.1	17.4	15.9	15.1	14.5	13.7	13.1	12.6	10.5	9.1
15		11	1740	120	44.0	42.3	40.0	38.3	36.7	25.4	23.2	22.0	21.2	20.0	19.1	18.3	15.3	13.3
20		15	1740	150	58.3	56.1	53.0	50.7	48.6	33.7	30.7	29.2	28.1	26.5	25.3	24.3	20.3	17.7
25		18.5	1740	180	69.3	66.6	63.0	60.3	57.8	40.1	36.5	34.7	33.4	31.5	30.1	28.9	24.1	21.0
30		22	1740	220	80.3	77.2	73.0	69.8	66.9	46.4	42.3	40.2	38.7	36.5	34.9	33.5	27.9	24.3
40		30	1740	240	106.7	102.6	97.0	92.8	88.9	61.7	56.2	53.4	51.4	48.5	46.4	44.5	37.1	32.3
1/4		6P	0.18	1140	13	1.21	1.16	1.10	1.05	1.01	0.70	0.64	0.61	0.58	0.55	0.53	0.50	0.42
1/2	0.37		1140	16	2.42	2.33	2.20	2.10	2.02	1.40	1.27	1.21	1.17	1.10	1.05	1.01	0.84	0.73
1	0.75		1140	22	4.2	4.0	3.8	3.6	3.5	2.4	2.2	2.1	2.0	1.9	1.8	1.7	1.5	1.3
2	1.5		1140	30	7.7	7.4	7.0	6.7	6.4	4.5	4.1	3.9	3.7	3.5	3.3	3.2	2.7	2.3
3	2.2		1140	38	11.0	10.6	10.0	9.6	9.2	6.4	5.8	5.5	5.3	5.0	4.8	4.6	3.8	3.3
5	3.7		1160	65	16.5	15.9	15.0	14.3	13.8	9.5	8.7	8.3	8.0	7.5	7.2	6.9	5.7	5.0
7.5	5.5		1160	73	27.0	25.9	24.5	23.4	22.5	15.6	14.2	13.5	13.0	12.3	11.7	11.2	9.4	8.2
10	7.5		1160	120	31.9	30.7	29.0	27.7	26.6	18.4	16.8	16.0	15.4	14.5	13.9	13.3	11.1	9.7
15	11		1170	150	49.1	47.2	44.6	42.7	40.9	28.4	25.8	24.5	23.6	22.3	21.3	20.4	17.1	14.9
20	15		1170	180	66.0	63.5	60.0	57.4	55.0	38.2	34.7	33.0	31.8	30.0	28.7	27.5	23.0	20.0
25	18.5		1170	220	80.3	77.2	73.0	69.8	66.9	46.4	42.3	40.2	38.7	36.5	34.9	33.5	27.9	24.3
30	22		1170	240	106.7	102.6	97.0	92.8	88.9	61.7	56.2	53.4	51.4	48.5	46.4	44.5	37.1	32.3



# 各型幫浦可生產馬達規格表

Motor spec for various type of pumps

specification		3-Phase														Single-phase					
Type	6P	-	1/4	1/2	1	2	3	5	7 1/2	10	15	20	30								
	4P	1/4	1/2	1	2	3	5	7 1/2	10	15	20	30	40	40	1/4	1/2	1	2	3	5	
Induction		LW	LW	LW	LW	LW	LW	LW	LW	LW	LW	LW	LW	LW	LW	LW	LW	LW	LW	LW	LW
NOP	W														LW						
PA		LW	LW	LW	LW	LW	LW	LW	LW	LW						LW	LW	LW	LW	LW	W
20L		LW		LW	LW	LW	LW									LW	LW	LW			
TFP		LW	LW	LW	LW	LW	LW														
1A		LW	LW	LW	LW	LW	LW									LW	LW	LW			
TOP		W	W	W	W											W	W	W			
五分		LW	LW	LW	LW	LW	LW	LW	LW							LW	LW	LW	LW	LW	W
DS		W	LW	LW	LW	LW	LW	LW	LW							LW	LW	LW	LW	LW	W
1P			LW	LW	LW	LW	LW	LW	LW								LW	LW	LW	LW	W
FA1		W	LW	W	W	LW	LW	LW	LW	LW	W	W	W				LW	LW	LW	LW	W
30L		W	W	LW	LW	LW	LW	LW	LW	LW	W	W	W			LW	LW	LW	LW	LW	W
PB			LW	W	W	LW	LW	LW	LW	LW	W	W	W				LW	LW	LW	LW	W
50T			W	LW	LW	LW	LW	LW	LW	LW	W	W	W			W	LW	LW	LW	LW	W
PV2R2					LW	LW	LW	LW	LW	LW	W	W	W							LW	W
T6C					LW	LW	LW	LW	LW	LW	W	W	W							LW	W
VDC					LW	LW	LW	LW	LW	LW	W	W	W								
T6B					LW	LW	LW	LW	LW	LW	W	W	W							LW	W
150T						LW	LW	LW	LW	LW	W	W	W								
T6D							LW	LW	LW	LW	W	W	W								
VQ45										W	W	W	W	W							

## Remarks:

1. 1/4HP~40HP

2. L=Vertical type W=Horizontal type

3. Pole: 2P/4P/6P/8P

4. Phase: 3-phase/Single-phase

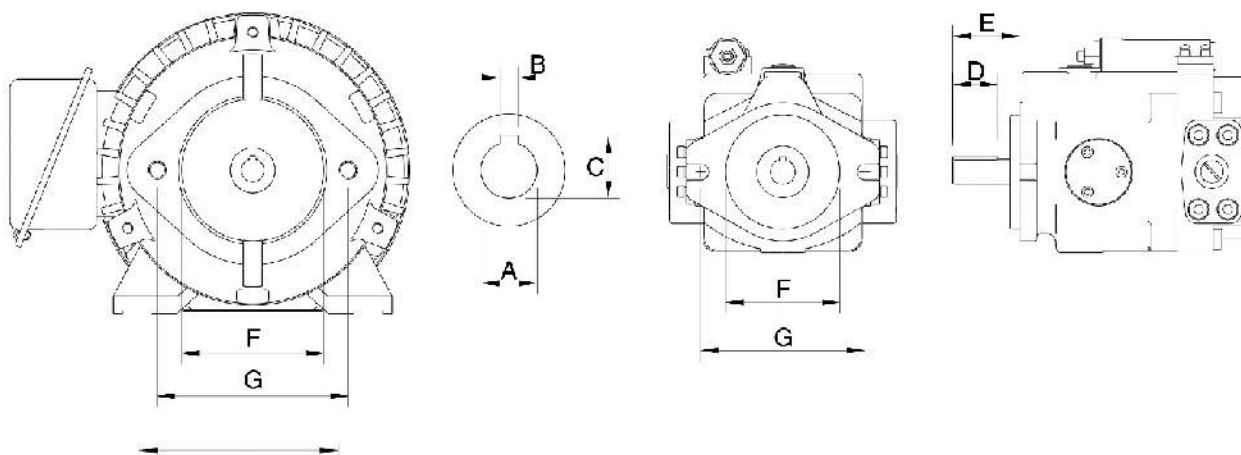



# 各型幫浦尺寸規格表

## Dimension of Pumps

pump type	General pump model number	Axile Dimension AXB	Key Dimension			I.D F	Span G	Install screw H
			C	D	E			
NOP	AM5,5A,NOP, TOP	Φ5x9			11	30	45	M6x1.0
20L	VPE-F8/12/15/20/24,VA1	Φ12.7x3.175	14.2	19	36	Φ82.55	106	M10x1.5
	VCM-SF-12/20	Φ12.7x3.175	14.3	19.05	36.5	Φ82.55	106	M10x1.5
TFP	TFP	Φ12x3	13.6	25	40	Φ30	56x73	M6x1.0
1A	HSP-1A	Φ12x4	14	16	28.8	Φ30	□64x64	M6x1.0
TOP		Φ14x4	16	40	45	Φ47	68	M8x1.25
5分	VVP-F8/12/15/20(雙連)	Φ15.875x4	17.7	19	36	Φ82.55	106	M10x1.5
	IG2F	Φ15.875x4	17.73	34	59	Φ82.55	106.4	M10x1.5
	GE4-26	Φ15.875x4	17.72	34	31.5	Φ82.55	106.36	M10x1.5
	3A,HP2	Φ15.875x4	17.6	18	31.8	Φ82.55	106.4	M10x1.5
DS	DS,FB1	Φ16x5	18.2	18.5	28	Φ70	98	M8x1.25
1P	1P	Φ17.46x5	19.6	40	50	Φ82.55	106.4	M10x1.5
GSP2	內田	Φ18x6	20.5	45	55	Φ80	71.5x100偏下	M8x1.25
BCP	IG2E	Φ18x6	20.5	30	41	Φ82.55	106.4	M10x1.5
	DEG4-26	Φ18x6	20.5	28	50	Φ82.55	106.36	M10x1.5
GP2-85	王冠	Φ19.05x4.76	21.4	40	50	Φ70	95.3x31.8偏上	M8x1.25
FA1	VCM-1M,PV2R1	Φ19.05x4.76	21.24	25	44.5	Φ82.55	106	M10x1.5
	VQ15	Φ19.05x4.76	21.24	27	53.5	Φ82.55	106	M10x1.5
	A16,A22,FA1	Φ19.05x4.76	21.25	22	46	Φ82.6	106.3	M10x1.5
30L	VCM-SF-30/40,VPE-F25/30/40	Φ19.05x4.76	21.4	22	37	Φ95.02	□90x90	M10x1.5
	VD2	Φ19.05x4.76	21.4	22	37	Φ95.02	□90x90	M10x1.5
	50T(Φ19)	Φ19.05x4.76	21.4	25	50	Φ95	□90x90	M10x1.5
PB	PB	Φ20x5	22.5	32	40	Φ82.55	106	M10x1.5
	IG3E	Φ20x6	20.5	30	41	Φ101.6	146	M12x1.75
50T	VCM-50T	Φ22x5	24	28	50	Φ96	□90x90	M10x1.5
	50T	Φ22x5	24	28	55	Φ96	□90x90	M10x1.5
PV2R2舊	PV2R2(福南)	Φ22.2x4.76	24.7	50	60	Φ101.6	146	M12x1.75
T6C	A37, PV2R2	Φ22.2x6.35	25.08	35	58.5	Φ101.6	146	M12x1.75
T6C	V23,V38	Φ22.23x6.35	25.08	35	58.5	Φ101.6	146	M12x1.75
	VQ25	Φ22.23x6.35	25.01	32	60.5	Φ101.6	146	M12x1.75
VDC	45A	Φ25.4x4.76	27.6	38	78	Φ135	□124	M12x1.75
T6B	PV2R2	Φ25.4x6.35	28.18	32	89	Φ101.6	146	M12x1.75
	PV2R12,VCM-12M	Φ25.4x6.35	28.18	40	67	Φ101.6	146	M12x1.75
	VCM-2M	Φ25.4x6.35	28.18	32	59	Φ101.6	146	M12x1.75
150T	150T四孔	Φ30x7	33	32	50.5	Φ160	187	M12x1.75
	150T六孔	Φ30x7	33	31.5	50.5	Φ160	187	M12x1.75
T6D	IG5F	Φ31.75x7.94	35.33	50	85	Φ127	181	M16x2.0
	VCM-3M,PV2R3,VCM-13M/23M	Φ31.75x7.94	35.32	40	75	Φ127	181	M16x2.0
	VQ35	Φ31.75x7.94	35.32	46	75	Φ127	181	M16x2.0
	V50/V70	Φ31.75x7.94	35.35	38	57	Φ127	181	M16x2.0
VQ45	VQ425	Φ38.1x9.525	42.36	50	85.7	Φ127	181	M16x2.0
	VQ45	Φ38.1x9.525	42.36	50	83	Φ127	181	M16x2.0
PV2R4	SVQ45	Φ38.1x9.525	42.36	50	83	Φ152.4	□228.6x228.6	M20x2.75
	SVQ435	Φ38.1x9.525	42.36	50	84	Φ152.4	□228.6x228.6	M20x2.75